

ITEM	DESCRIPTION	QUANTITY
1	CHANNEL PROFILE	1
2	RIVET CONNECTION	2
3	ROUNDED HEADED ANCHOR	2
4	END CAP	2
5	TEAR OUT BAND	1
6	FILLER FOAM	1
7	STEEL STRAP	1
8	STEEL PLATE	1
9	SELF DRILL SCREW	3
10	M8 REBAR	4

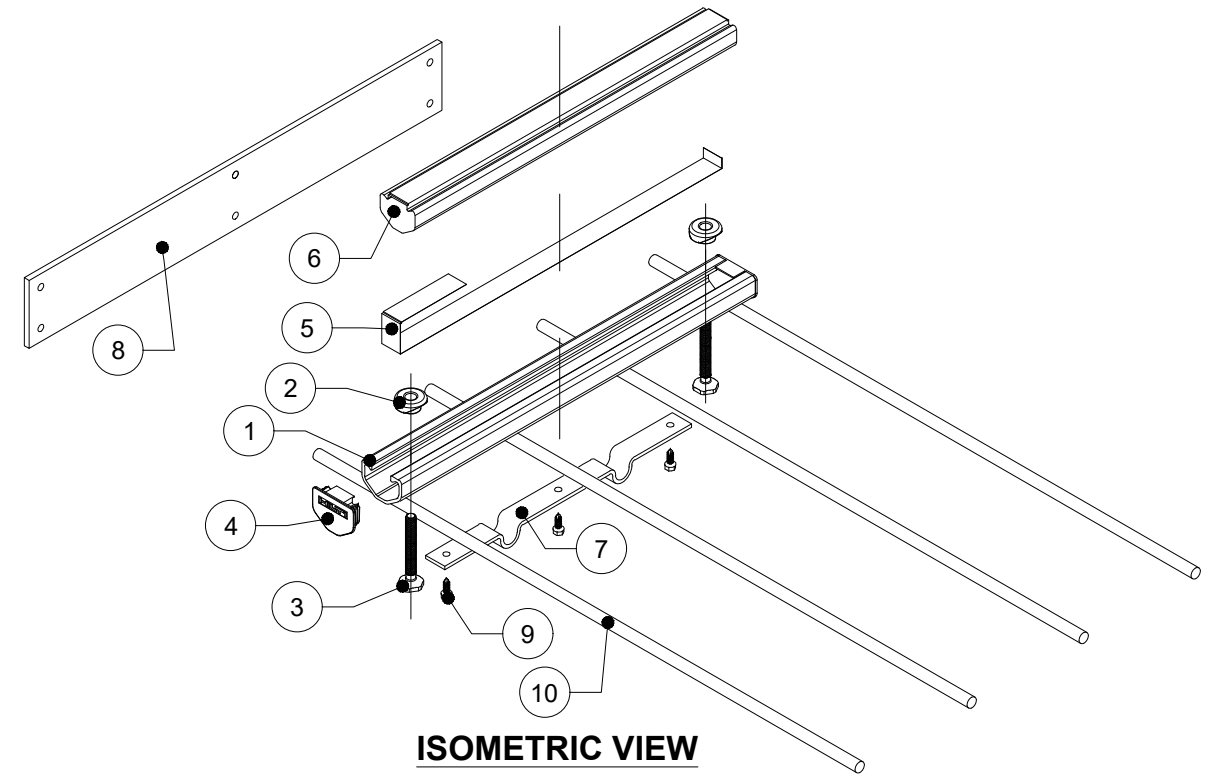
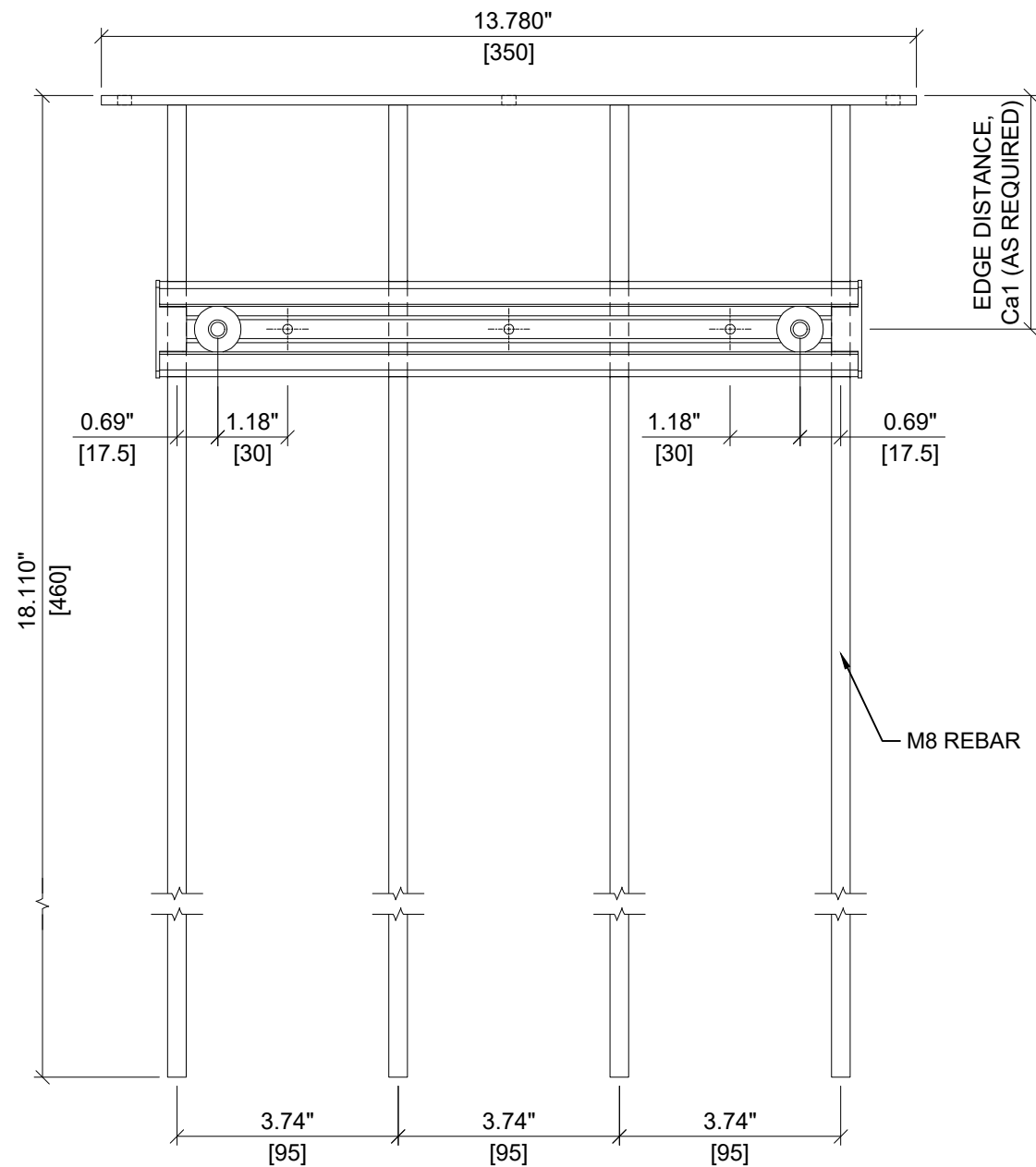

Notes:

- HAC IS NOT STRUCTURALLY CONNECTED TO STEEL PLATE OR REBAR.
- ICC APPROVAL APPLIES TO HILTI ANCHOR CHANNEL COMPONENT.
- ITEM NUMBER VARIES ACCORDING TO THE REQUIRED EDGE DISTANCE. PLEASE CONTACT HILTI TO VERIFY ITEM NUMBERS FOR REQUIRED EDGE DISTANCES.

ITEM NUMBER: **VARIES³**

CHANNEL LIP: **SMOOTH**

ITEM DESCRIPTION: **HAC-40 91/300 F EDGE LITE**

