



Classified by
Underwriters Laboratories, Inc.
to UL 2079 and CAN/ULC-S115

System No. HW-S-0038

HWS 0038

ANSI/UL2079	CAN/ULC S115
Assembly Rating — 2 Hr	F Rating — 2 Hr
Joint Width - 3 In Max.	FT Rating — 2 Hr
	FH Rating — 2 Hr
	FTH Rating — 2 Hr
	Joint Width - 3 In Max.

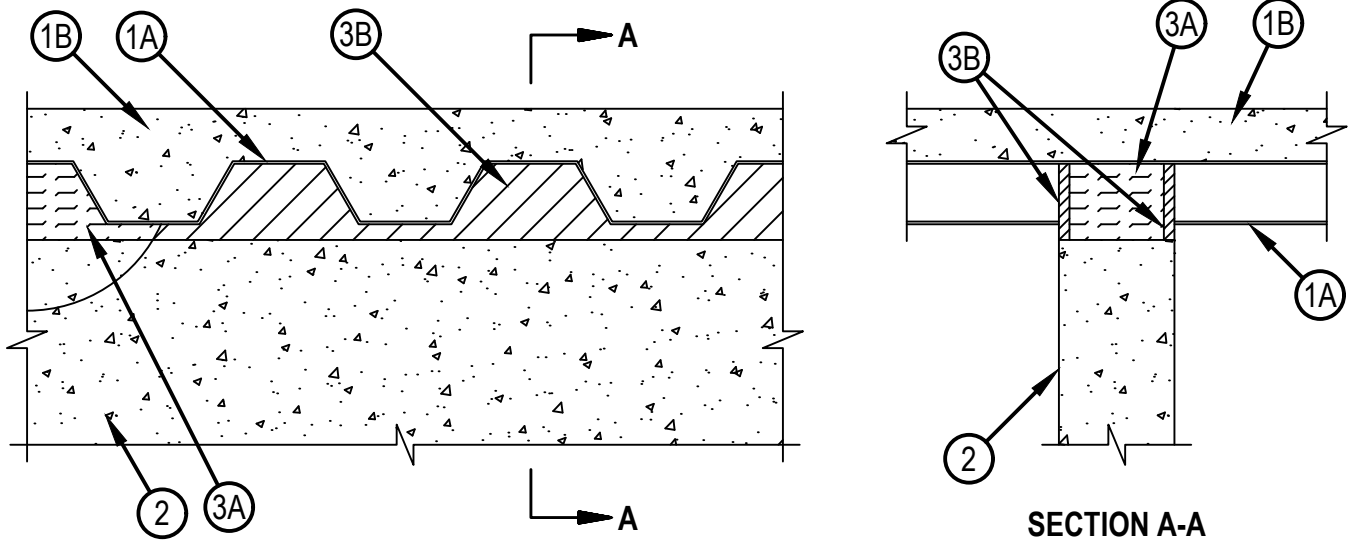

1. Floor Assembly — The fire-rated fluted steel deck/concrete floor assembly shall be constructed of the materials and in the manner described in the individual Floor-Ceiling Design in the UL Fire Resistance Directory and shall include the following construction features:
 - A. Steel Floor and Form Units* — Max 3 in. (76 mm) deep galv steel fluted floor units.
 - B. Concrete — Min 2-1/2 in. (64 mm) thick reinforced concrete, as measured from the top plane of the floor units.
2. Wall Assembly — Min 5-1/2 in. (140 mm) thick reinforced lightweight or normal weight (100-150 pcf or 1600-2400 kg/m³) structural concrete. Wall may also be constructed of any UL Classified Concrete Blocks*

See Concrete Blocks (CAZT) category in the Fire Resistance Directory for names of manufacturers.
3. Joint System — Separation between bottom of floor and top of wall (at time of installation of joint system) is min 3/4 in. (19 mm) to max 3 in. (76 mm) — The joint system consists of a packing material and a fill material in the flutes of the steel floor units and between the top of the wall and the bottom of the steel floor units, as follows:
 - A. Packing Material — Min 4-1/2 in. (114 mm) thickness of min 4 pcf (64 kg/m³) density mineral wool batt insulation firmly packed into flutes of the steel floor units and between the top of the wall and the bottom of the steel deck as a permanent form. Packing material to be recessed from each side of wall as required to accommodate the required thickness of fill material.
 - B. Fill, Void or Cavity Material* — Min 1/2 in. (13 mm) thickness of fill material installed on each side of the wall in the flutes of the steel floor units and between the top of the wall and the bottom of the steel floor units, flush with each surface of wallboard.

HILTI CONSTRUCTION CHEMICALS, DIV OF HILTI INC — FS-ONE Sealant or FS-ONE MAX Intumescent Sealant.

* Indicates such products shall bear the UL or cUL Certification Mark for jurisdictions employing the UL or cUL Certification (such as Canada), respectively.



Hilti Firestop Systems

Reproduced by HILTI, Inc. Courtesy of
Underwriters Laboratories, Inc.
January 28, 2015