

UL/cUL SYSTEM NO. HW-D-0209

**TOP OF WALL JOINT : GYPSUM WALL ASSEMBLY**

ASSEMBLY RATING = 1-HR., 2-HR., 3-HR., OR 4-HR.

CLASS II MOVEMENT CAPABILITIES - 19% COMPRESSION OR EXTENSION, 33% COMPRESSION OR 16% EXTENSION, OR 43% COMPRESSION

(SEE NOTE NO. 1 BELOW)

L-RATING AT AMBIENT = LESS THAN 1 CFM / LIN FT (SEE NOTE NO. 3 BELOW)

L-RATING AT 400°F = LESS THAN 1 CFM / LIN FT (SEE NOTE NO. 3 BELOW)

HW-D-0209k-052021

**FRONT VIEW**

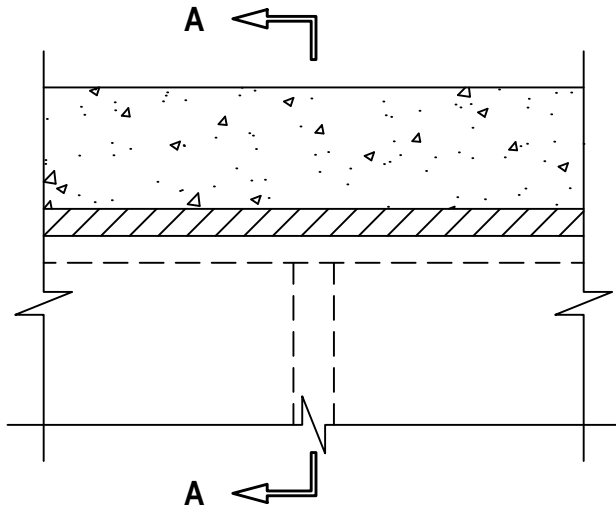

**SECTION A-A**

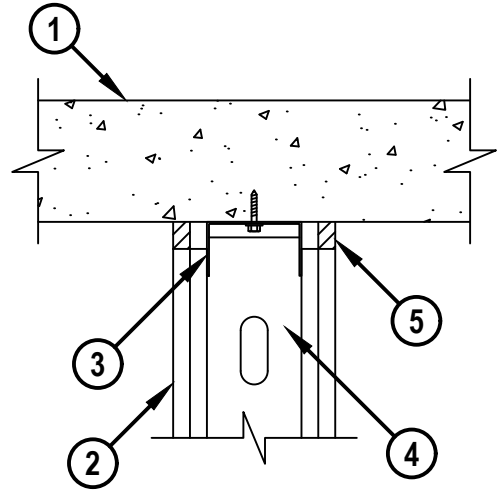

HILTI, Inc.  
Plano, Texas USA (800) 879-8000

Sheet	1 of 2
Scale	9/64" = 1"
Date	May 20, 2021

Drawing No.  
**HWD  
0209k**

*Saving Lives through Innovation and Education*

UL/cUL SYSTEM NO. HW-D-0209

**TOP OF WALL JOINT : GYPSUM WALL ASSEMBLY**

ASSEMBLY RATING = 1-HR., 2-HR., 3-HR., OR 4-HR.

CLASS II MOVEMENT CAPABILITIES - 19% COMPRESSION OR EXTENSION, 33% COMPRESSION OR 16% EXTENSION, OR 43% COMPRESSION  
(SEE NOTE NO. 1 BELOW)

L-RATING AT AMBIENT = LESS THAN 1 CFM / LIN FT (SEE NOTE NO. 3 BELOW)

L-RATING AT 400°F = LESS THAN 1 CFM / LIN FT (SEE NOTE NO. 3 BELOW)

HWDD0209k.052021

**1. CONCRETE FLOOR ASSEMBLY :**

A. LIGHTWEIGHT OR NORMAL WEIGHT CONCRETE FLOOR (MINIMUM 4-1/2" THICK).

B. ANY UL/cUL CLASSIFIED PRECAST (HOLLOW-CORE) CONCRETE FLOOR (MINIMUM 6" THICK).

**2. GYPSUM WALL ASSEMBLY (UL/cUL CLASSIFIED U400, V400, OR W400 SERIES) (1-HR., 2-HR., 3-HR., OR 4-HR. FIRE-RATING) (2-HR. SHOWN). HOURLY RATING OF THE JOINT SYSTEM IS EQUAL TO THE HOURLY RATING OF THE WALLS.**

**3. CEILING RUNNER (MIN. 25 GA., FLANGE HEIGHT OF CEILING RUNNER SHALL BE MINIMUM 1/4" GREATER THAN MAXIMUM EXTENDED JOINT WIDTH) FASTENED TO UNDERSIDE OF CONCRETE FLOOR WITH STEEL MASONRY ANCHORS OR STEEL FASTENERS (SPACED MAX. 24" O.C.) (SEE NOTE NO. 2 BELOW).**

**4. STEEL STUDS (MIN. 3-1/2" WIDE), CUT 1/2" TO 3/4" LESS IN LENGTH THAN ASSEMBLY HEIGHT, NESTING IN CEILING RUNNER WITHOUT ATTACHMENT.**

**5. HILTI CP 601S ELASTOMERIC FIRESTOP SEALANT, HILTI CP 606 FLEXIBLE FIRESTOP SEALANT, OR HILTI CFS-S SIL GG FIRESTOP SILICONE SEALANT :**

A. MINIMUM 5/8" DEPTH OF SEALANT FOR 1-HR. AND 2-HR. FIRE-RATING.

B. MINIMUM 1" DEPTH OF SEALANT FOR 3-HR. AND 4-HR. FIRE-RATING.

**NOTES : 1. ALLOWABLE JOINT WIDTHS TO BE DETERMINED AS FOLLOWS :**

A. FOR 1-HR. OR 2-HR. WALLS TO ACCOMMODATE MAXIMUM 19% COMPRESSION OR EXTENSION, MAXIMUM WIDTH OF JOINT = 1".

B. FOR 3-HR. OR 4-HR. WALLS TO ACCOMMODATE MAXIMUM 33% COMPRESSION OR 16% EXTENSION, MAXIMUM WIDTH OF JOINT = 3/4".

C. FOR 3-HR. OR 4-HR. WALLS TO ACCOMMODATE MAXIMUM 43% COMPRESSION ONLY, MAXIMUM WIDTH OF JOINT = 7/8".

2. AS AN ALTERNATE TO CEILING RUNNER IN ITEM NO. 3, SLOTTED CEILING RUNNERS MAY BE USED. CONSULT THE UL FIRE RESISTANCE DIRECTORY FOR APPROVED MANUFACTURERS.

3. L-RATING ONLY APPLIES WHEN HILTI CP 606 FLEXIBLE FIRESTOP SEALANT OR HILTI CFS-S SIL GG FIRESTOP SILICONE SEALANT IS USED.

4. [OPTIONAL, NOT SHOWN] MINERAL WOOL, FIBERGLASS, OR POLYURETHANE/POLYETHYLENE FOAM BACKER ROD MAY BE USED AS A BACKER IN 2-HR., 3-HR., OR 4-HR. WALLS.



**Hilti Firestop Systems**

HILTI, Inc.  
Plano, Texas USA (800) 879-8000

Sheet 2 of 2

Scale -

Date May 20, 2021

Drawing No.

**HWD  
0209k**

*Saving Lives through Innovation and Education*