

UL/cUL SYSTEM NO. HW-D-0396

**TOP OF WALL JOINT : GYPSUM WALL ASSEMBLY**

ASSEMBLY RATING = 1-HR. OR 2-HR.

CLASS II MOVEMENT CAPABILITIES - 17% COMPRESSION OR EXTENSION

L-RATING AT AMBIENT = LESS THAN 1 CFM/LIN FT

L-RATING AT 400°F = LESS THAN 1 CFM/LIN FT

**CROSS-SECTIONAL VIEW**

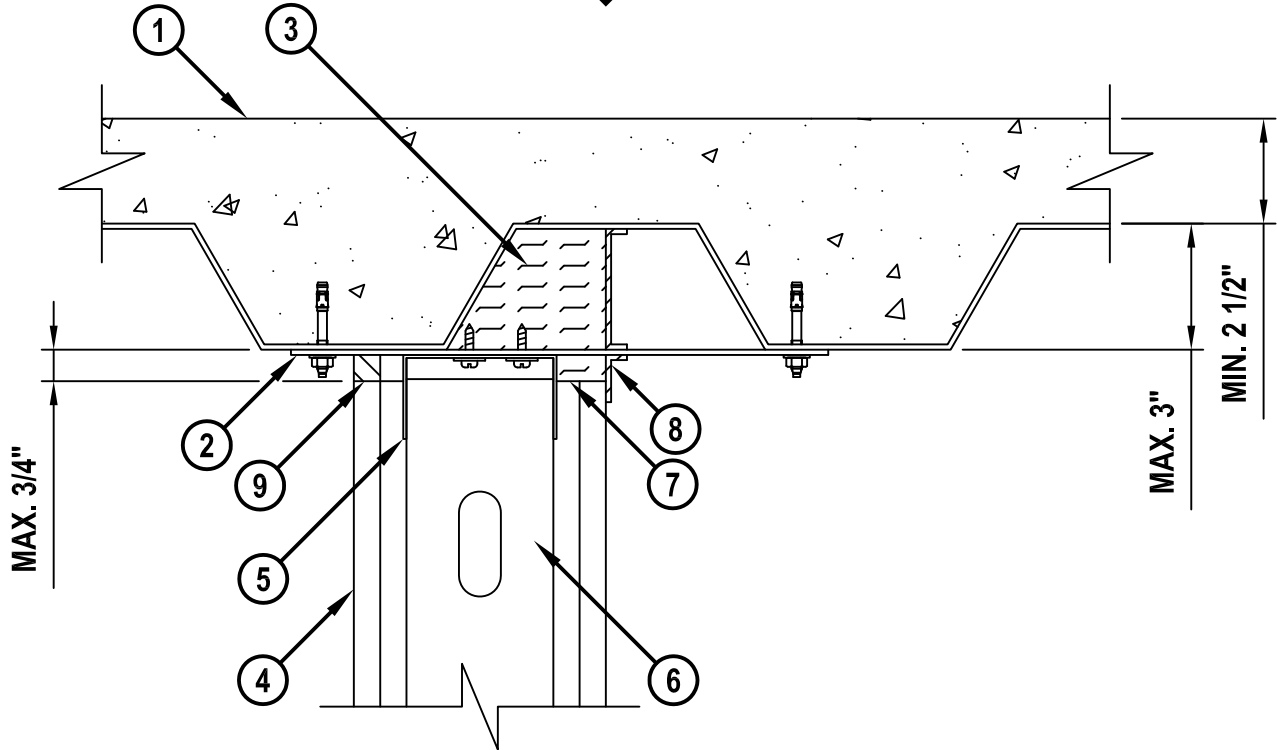

HW-D-0396e-030312

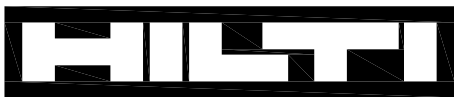

**Hilti Firestop Systems**

HILTI, Inc.  
Tulsa, Oklahoma USA (800) 879-8000

Sheet	1 of 2
Scale	7/32" = 1"
Date	Mar. 03, 2012

Drawing No.

**HWD  
0396e**

*Saving Lives through Innovation and Education*

UL/cUL SYSTEM NO. HW-D-0396

**TOP OF WALL JOINT : GYPSUM WALL ASSEMBLY**

ASSEMBLY RATING = 1-HR. OR 2-HR.

CLASS II MOVEMENT CAPABILITIES - 17% COMPRESSION OR EXTENSION

L-RATING AT AMBIENT = LESS THAN 1 CFM/LIN FT

L-RATING AT 400°F = LESS THAN 1 CFM/LIN FT

HW0396e.030312

1. LIGHTWEIGHT OR NORMAL WEIGHT CONCRETE FLOOR OVER METAL DECKING ASSEMBLY (UL/cUL CLASSIFIED D900 SERIES) (MINIMUM 2-1/2" THICK) (1-HR. OR 2-HR. FIRE-RATING).
2. MINIMUM 2" WIDE, 16 GA., STEEL STRAPS CUT TO A LENGTH TO SPAN THE FLUTE AND OVERLAP THE ADJACENT VALLEYS BY 1-1/2". STEEL STRAPS SPACED MAXIMUM 24" ON CENTER AND FASTENED TO FLOOR ASSEMBLY WITH STEEL MASONRY ANCHORS OR STEEL FASTENERS.
3. HILTI CP 777 SPEED PLUGS FRICTION FITTED TO COMPLETELY FILL FLUTES. ADJACENT LENGTHS OF SPEED PLUGS TO BE TIGHTLY BUTTED WITH SEAMS SPACED MINIMUM 24" APART ALONG LENGTH OF PLUGS.
4. GYPSUM WALL ASSEMBLY (UL/cUL CLASSIFIED U400, V400, OR W400 SERIES) (1-HR. OR 2-HR. FIRE-RATING) (2-HR. SHOWN).
5. CEILING RUNNER (MINIMUM 25 GA., FLANGE HEIGHT OF CEILING RUNNER SHALL BE MINIMUM 1/4" GREATER THAN MAXIMUM EXTENDED JOINT WIDTH) INSTALLED PARALLEL TO DIRECTION OF STEEL FLOOR UNITS AND SECURED TO STEEL STRAPS WITH TWO NO. 8 SELF-DRILLING, SELF-TAPPING STEEL SCREWS PER STRAP.
6. STEEL STUDS (MINIMUM 3-1/2" WIDE) CUT 1/2" TO 3/4" LESS IN LENGTH THAN ASSEMBLY HEIGHT, NESTING IN CEILING RUNNER WITHOUT ATTACHMENT.
7. HILTI CP 767 SPEED STRIPS OR MINERAL WOOL SAFING (MIN. 4 PCF DENSITY) COMPRESSED 50%.
8. MINIMUM 1/8" (WET) THICKNESS HILTI CFS-SP WB FIRESTOP JOINT SPRAY OR HILTI CP 672 SPEED SPRAY TO COMPLETELY COVER MINERAL WOOL, OVERLAPPING MINIMUM 1/2" ONTO GYPSUM WALL, STEEL STRAP AND METAL DECK.
9. MINIMUM 5/8" DEPTH HILTI CP 606 FLEXIBLE FIRESTOP SEALANT.

**NOTES :** 1. MAXIMUM WIDTH OF JOINT = 3/4".  
 2. AS AN ALTERNATE TO CEILING RUNNER IN ITEM NO. 5, SLOTTED CEILING RUNNERS MAY BE USED. CONSULT THE UL FIRE RESISTANCE DIRECTORY FOR APPROVED MANUFACTURERS.  
 3. [OPTIONAL, NOT SHOWN] MINERAL WOOL, FIBERGLASS, OR POLYURETHANE/POLYETHYLENE FOAM BACKER ROD MAY BE USED AS A BACKER FOR CP 606 IN 2-HR. WALLS.

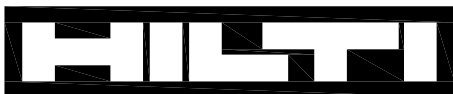

**Hilti Firestop Systems**

HILTI, Inc.  
Tulsa, Oklahoma USA (800) 879-8000

Sheet	2 of 2
Scale	-
Date	Mar. 03, 2012

Drawing No.

**HWD  
0396e**

*Saving Lives through Innovation and Education*