

UL/cUL SYSTEM NO. WW-D-1080

FIRE-RATED JOINT THROUGH CONCRETE WALL ASSEMBLY

ASSEMBLY RATING = 2-HR.

CLASS II MOVEMENT CAPABILITIES - 17% COMPRESSION OR EXTENSION

L-RATING AT AMBIENT = LESS THAN 1 CFM/LIN. FT.

L-RATING AT 400°F = LESS THAN 1 CFM/LIN. FT.

WWD1080a.092409

TOP VIEW

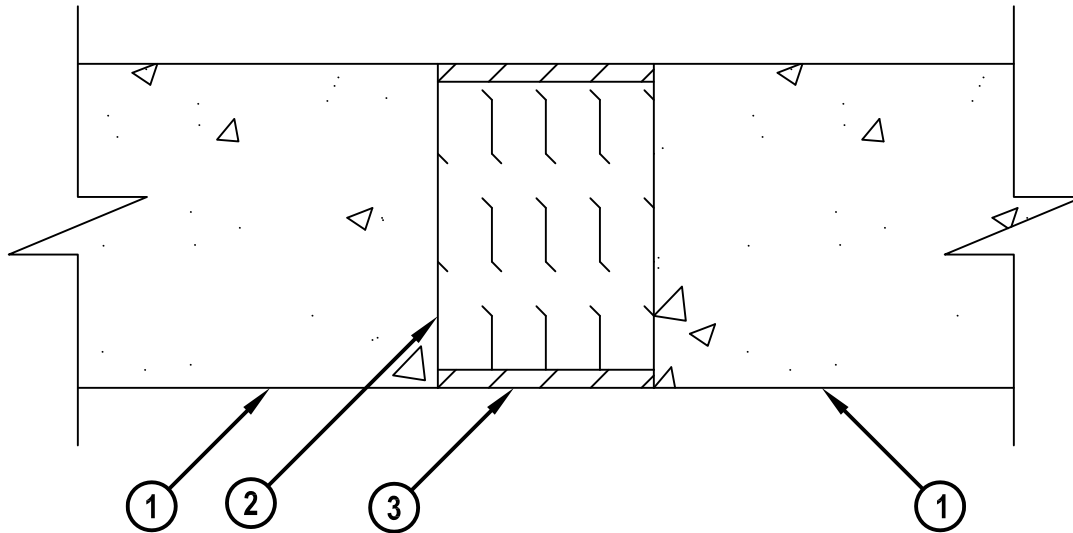

1. CONCRETE WALL ASSEMBLY (2-HR. FIRE-RATING) :
 - A. LIGHTWEIGHT OR NORMAL WEIGHT CONCRETE WALL (MINIMUM 4-1/2" THICK).
 - B. ANY UL/cUL CLASSIFIED CONCRETE BLOCK WALL.
2. MINIMUM 4" THICKNESS MINERAL WOOL (MIN. 4 PCF DENSITY) COMPRESSED 40%.
3. MINIMUM 1/4" DEPTH HILTI CP 606 FLEXIBLE FIRESTOP SEALANT.

NOTE : MAXIMUM WIDTH OF JOINT = 3".

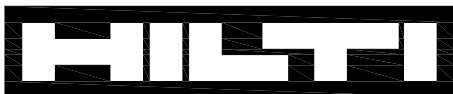

Hilti Firestop Systems

HILTI, Inc.
Tulsa, Oklahoma USA (800) 879-8000

Sheet	1 of 1
Scale	3/8" = 1"
Date	Sep. 28, 2009

Drawing No.

**WWD
1080a**

Saving Lives through Innovation and Education