

UL/cUL SYSTEM NO. HW-D-0703

**TOP OF WALL JOINT : CONCRETE WALL OR BLOCK WALL ASSEMBLY**

ASSEMBLY RATING = 2-HR.

CLASS II AND CLASS III MOVEMENT CAPABILITIES - 25% COMPRESSION OR EXTENSION

**CROSS-SECTIONAL VIEW**

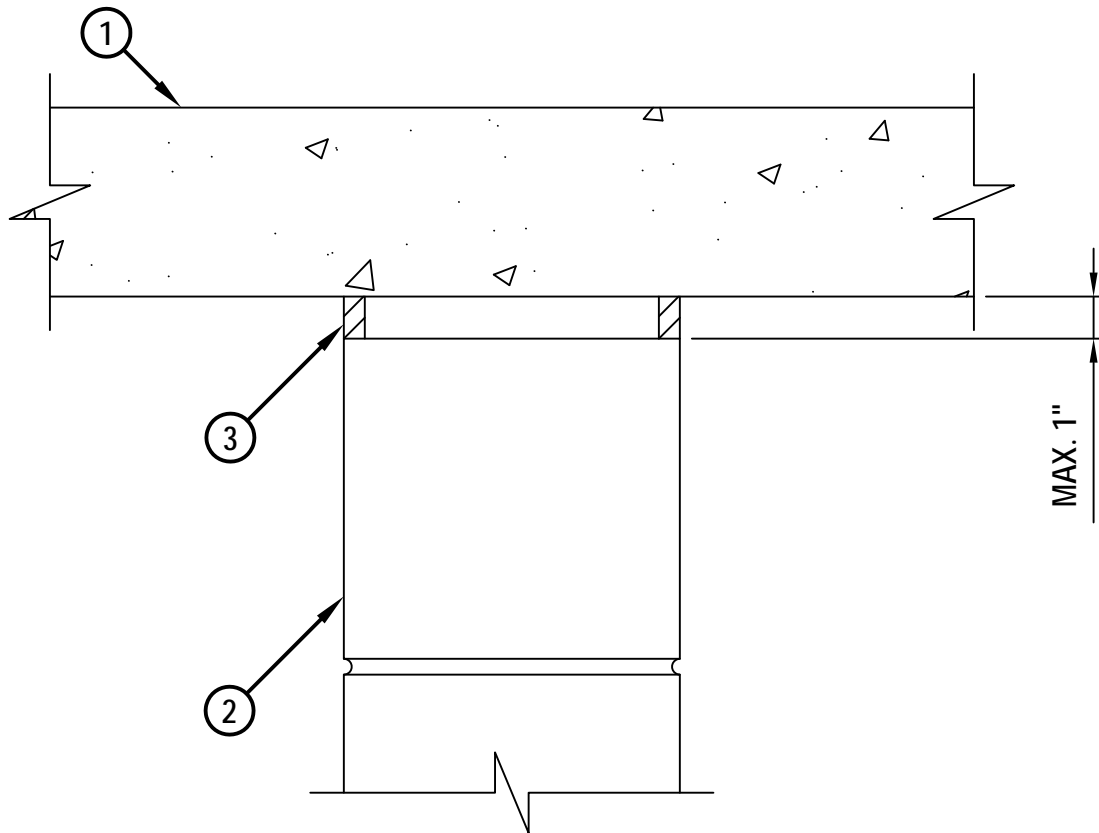

HW0703a.010814

1. CONCRETE FLOOR ASSEMBLY (2-HR. FIRE-RATING) :
  - A. LIGHTWEIGHT OR NORMAL WEIGHT CONCRETE FLOOR (MINIMUM 4-1/2" THICK).
  - B. ANY UL/cUL CLASSIFIED PRE-CAST HOLLOW CORE CONCRETE FLOOR (MINIMUM 6" THICK).
2. CONCRETE WALL ASSEMBLY (2-HR. FIRE-RATING) :
  - A. LIGHTWEIGHT OR NORMAL WEIGHT CONCRETE WALL (MINIMUM 5" THICK).
  - B. ANY UL/cUL CLASSIFIED CONCRETE BLOCK WALL.
3. MINIMUM 1/2" DEPTH HILTI CFS-S SIL GG FIRESTOP SILICONE SEALANT FLUSH WITH BOTH SURFACES OF WALL.

NOTES : 1. MAXIMUM WIDTH OF JOINT = 1".  
2. [OPTIONAL] [NOT SHOWN] MINERAL WOOL OR POLYURETHANE FOAM BACKER ROD MAY BE USED AS A BACKER FOR FIRESTOP SEALANT.



HILTI, Inc.  
Tulsa, Oklahoma USA (800) 879-8000

Sheet	1 of 1
Scale	7/32" = 1"
Date	Jan. 08, 2014

Drawing No.  
**HWD  
0703a**