



All loading and design criteria supplied by customer is assumed accurate. Only the stated Design Assumptions were considered, and must be verified by the responsible Engineer of Record (EOR). The basis of Hilti component and connection design is the published data in the current Hilti Technical Guide, including material and cross-section properties, allowable load values, factors of safety, methods of calculation, and limiting factors. The EOR must verify suitability for any specific application, and the capacity of the supportive structure to receive the shown configuration and associated reaction loads. Modification to components and/or design may alter performance and must be evaluated by the EOR.

TYPICAL DETAIL TYPE:

CABLE TRAY SUPPORT

TYPICAL DETAIL DESCRIPTION:

GOALPOST - BRIDGE

DESIGNED BY: KL	REVIEWED BY: AJV
--------------------	---------------------

DRAWN BY: BAP	ISSUE DATE: 03 DEC 14
------------------	--------------------------

REVISIONS:

NO.	DESCRIPTION:	DATE:
A	ORIGINAL ISSUE	03 DEC 14

TYPICAL DETAIL NOMENCLATURE:

CT-GP02-C

DRAWING NUMBER: 01	SHEET: 1/1
-----------------------	---------------

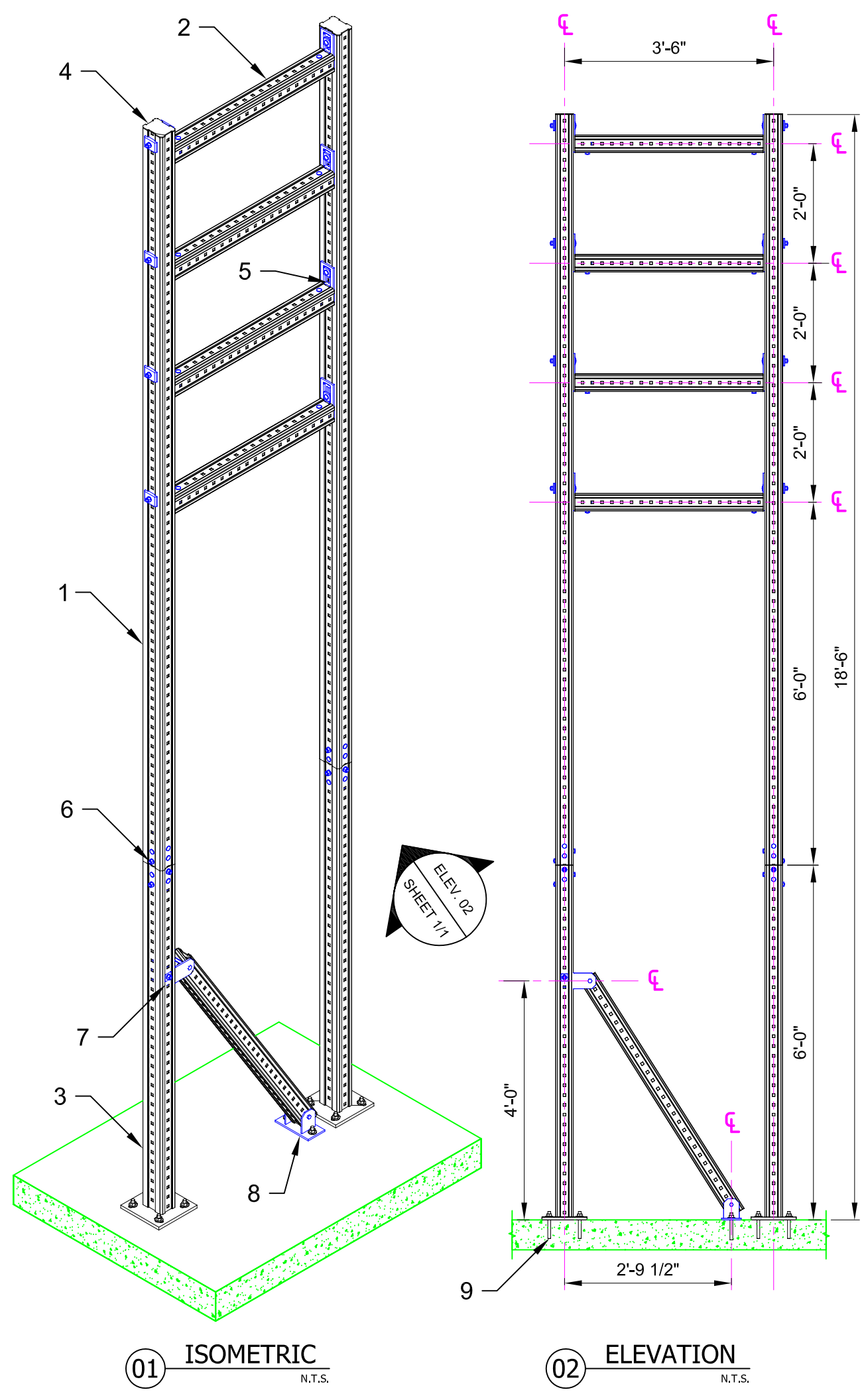

NOTE(S):
1. PRELIMINARY NOT FOR CONSTRUCTION
2. DESIGN ASSUMPTIONS:
a. DESIGN LOADS (STATIC, U.N.O.):
DL: 900 lbs ON EACH LEVEL
WL: 20 lbs/ft
b. LATERAL LOADS NOT CONSIDERED
c. CORROSION RESISTANCE REQD.: HDG / SS / EG
d. DESIGNED AT 8'-0" SPACING.
2. REFER TO COMPONENT MANUFACTURER'S IFUs FOR REQUIRED INSTALLATION INFO.

No.	Unit Qty	Unit	Description	Box Qty	# Boxes Needed	Item No.
1	AS REQ'D	EA	GIRDER MI-120 6M	1	AS REQ'D	304801
2	AS REQ'D	EA	GIRDER MI-90 3M	1	AS REQ'D	304798
3	2	EA	CONNECTOR MIC-C120-D-2000 WELDED BRACKET	1	2	270472
4	2	EA	GIRDER END CAP MIA-EC120	25	1	432078
5	8	EA	CONNECTOR MIC-90-U	4	2	304803
6	2	EA	CONNECTOR MIC-120-E	2	1	304810
7	1	PR	CONNECTOR MIC-U-MA	2	1	304806
8	1	EA	CONNECTOR MIC-CU-MA CONCRETE	4	1	304828
9	10	EA	USE KB3 OR KB-TZ AS APPROPRIATE	VARIES	VARIES	VARIES