



All loading and design criteria supplied by customer is assumed accurate. Only the stated Design Assumptions were considered, and must be verified by the responsible Engineer of Record (EOR). The basis of Hilti component and connection design is the published data in the current Hilti Technical Guide, including material and cross-section properties, allowable load values, factors of safety, methods of calculation, and limiting factors. The EOR must verify suitability for any specific application, and the capacity of the supportive structure to receive the shown configuration and associated reaction loads. Modification to components and/or design may alter performance and must be evaluated by the EOR.

TYPICAL DETAIL TYPE:
ELECTRICAL & INSTRUMENTATION APPLICATION

TYPICAL DETAIL DESCRIPTION:
BRACED PANEL STAND

DESIGNED BY: KL	REVIEWED BY: AJV
DRAWN BY: GAB	ISSUE DATE: 05 DEC 14

REVISIONS:

NO.	DESCRIPTION:	DATE:
A	ORIGINAL ISSUE	05 DEC 14

TYPICAL DETAIL NOMENCLATURE:
EI-BPS01-C

DRAWING NUMBER: 01	SHEET: 1/1
------------------------------	----------------------

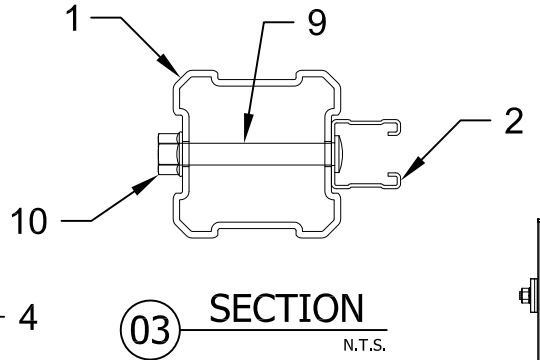
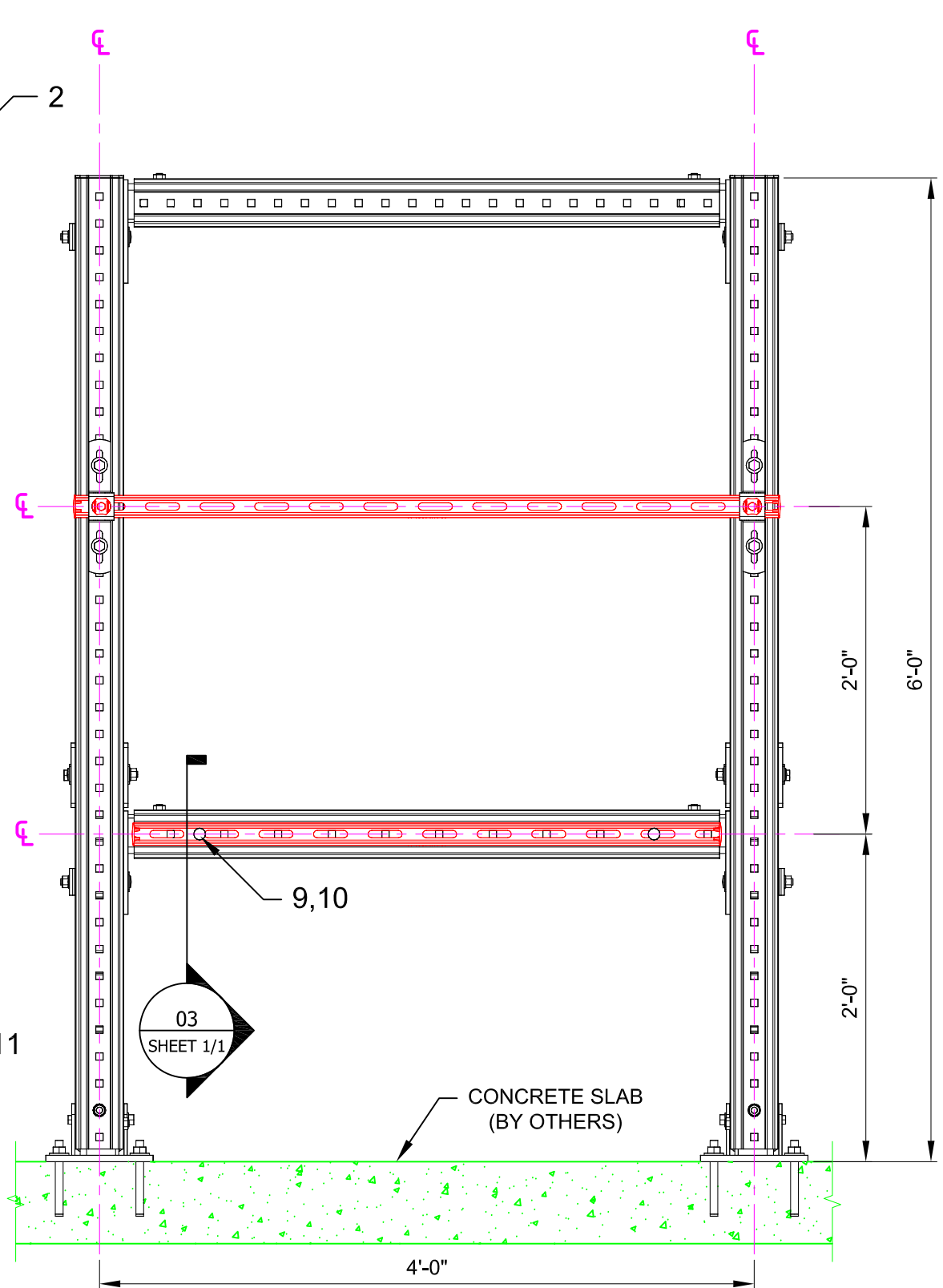
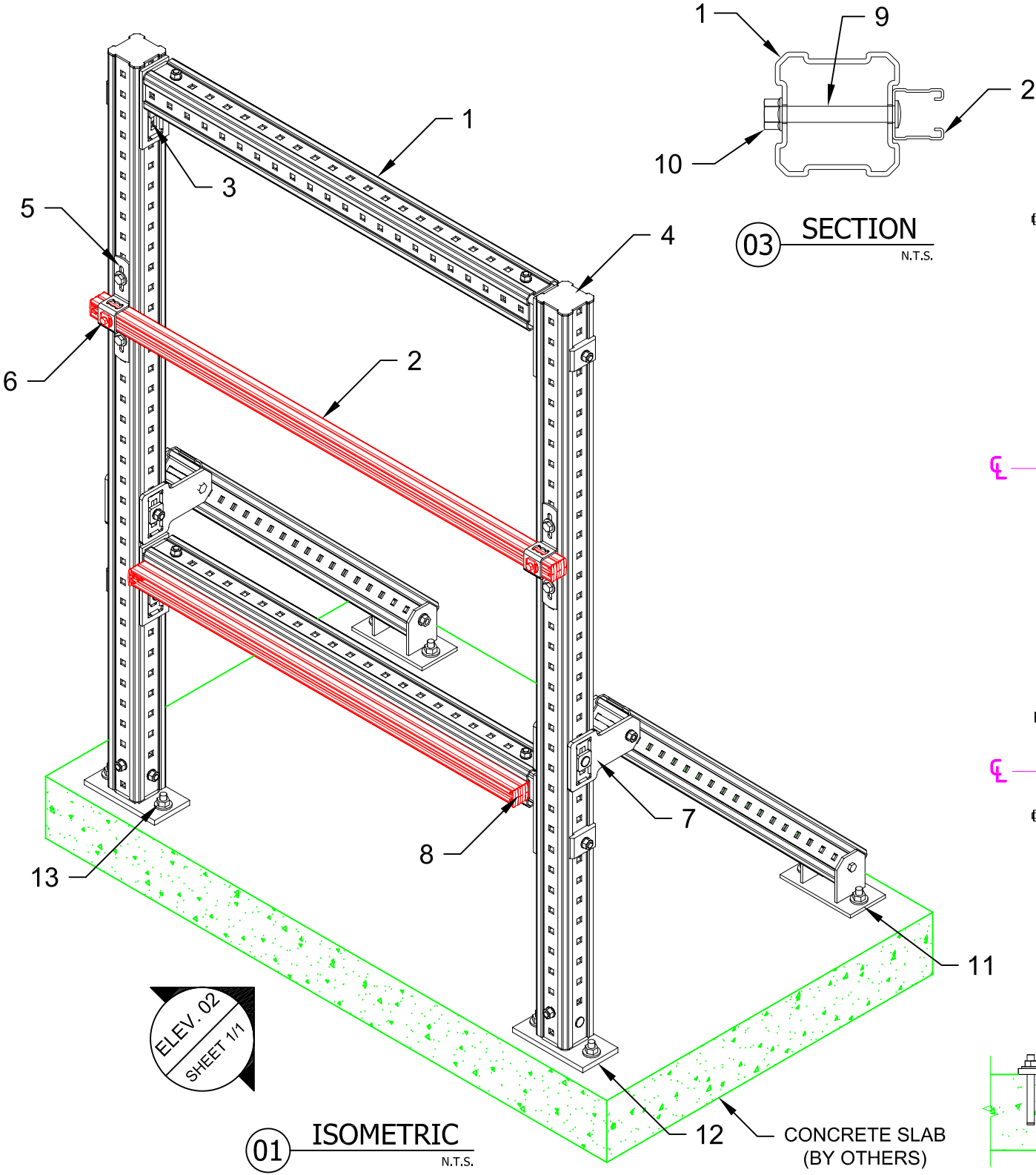

No.	Unit Qty	Unit	Description	Box Qty	# Boxes Needed	Item No.
1	AS REQ'D	EA	GIRDER MI-90 3M	1	AS REQ'D	304798
2	AS REQ'D	EA	STRUT HS-158-12/HDG 10'	1	AS REQ'D	407570
3	4	EA	CONNECTOR MIC-90-U	4	1	304803
4	2	EA	GIRDER END CAP MIA-EC90	25	1	432077
5	2	EA	CONNECTOR MIC-MI/MQ-X	16	1	304881
6	2	EA	CHANNEL CONNECTOR MQN-HDG PLUS	50	1	387779
7	2	PR	CONNECTOR MIC-U-MA	2	1	304806
8	8	EA	CHANNEL END CAP MEK GREY	50	1	313377
9	2	EA	ONEHAND SCREW MIA-OH90	10	1	304889
10	2	EA	MI HEX NUT M12-F-SL-WS 3/4"	100	1	382897
11	2	EA	CONNECTOR MIC-CU-MA CONCRETE	4	1	304828
12	2	EA	CONNECTOR MIC-C90-AA CONCRETE	2	1	304825
13	8	EA	USE KB3 OR KB-TZ AS APPROPRIATE	VARIES	VARIES	VARIES

NOTE(S):

- PRELIMINARY NOT FOR CONSTRUCTION
- DESIGN ASSUMPTIONS:
 - NO LOADS CONSIDERED - CONCEPT ONLY
 - LATERAL LOADS NOT CONSIDERED
 - BUILDING CODE: NOT SPECIFIED
 - CORROSION RESISTANCE REQD.: NOT SPECIFIED
- REFER TO COMPONENT MANUFACTURER'S IFUs FOR REQUIRED INSTALLATION INFO.
- E.O.R. MUST BE NOTIFIED OF ANY DEVIATIONS FROM EXISTING/NEW SUBSTRATE CONDITIONS SHOWN HEREIN TO VALIDATE ACCEPTANCE OF THIS HILTI DESIGN PRIOR TO INSTALLATION.