

All loading and design criteria supplied by customer is assumed accurate. Only the stated Design Assumptions were considered, and must be verified by the responsible Engineer of Record (EOR). The basis of Hilti component and connection design is the published data in the current Hilti Technical Guide, including material and cross-section properties, allowable load values, factors of safety, methods of calculation, and limiting factors. The EOR must verify suitability for any specific application, and the capacity of the supportive structure to receive the shown configuration and associated reaction loads. Modification to components and/or design may alter performance and must be evaluated by the EOR.

TYPICAL DETAIL TYPE:

ELECTRICAL & INSTRUMENTATION APPLICATION

TYPICAL DETAIL DESCRIPTION:

BRACED CABINET STAND

DESIGNED BY:
KL

REVIEWED BY:
AJV

DRAWN BY:
GAB

ISSUE DATE:
05 DEC 14

REVISIONS:

NO.	DESCRIPTION:	DATE:
A	ORIGINAL ISSUE	05 DEC 14

TYPICAL DETAIL NOMENCLATURE:

EI-BPS02-C

DRAWING NUMBER:
01

SHEET:
1/1

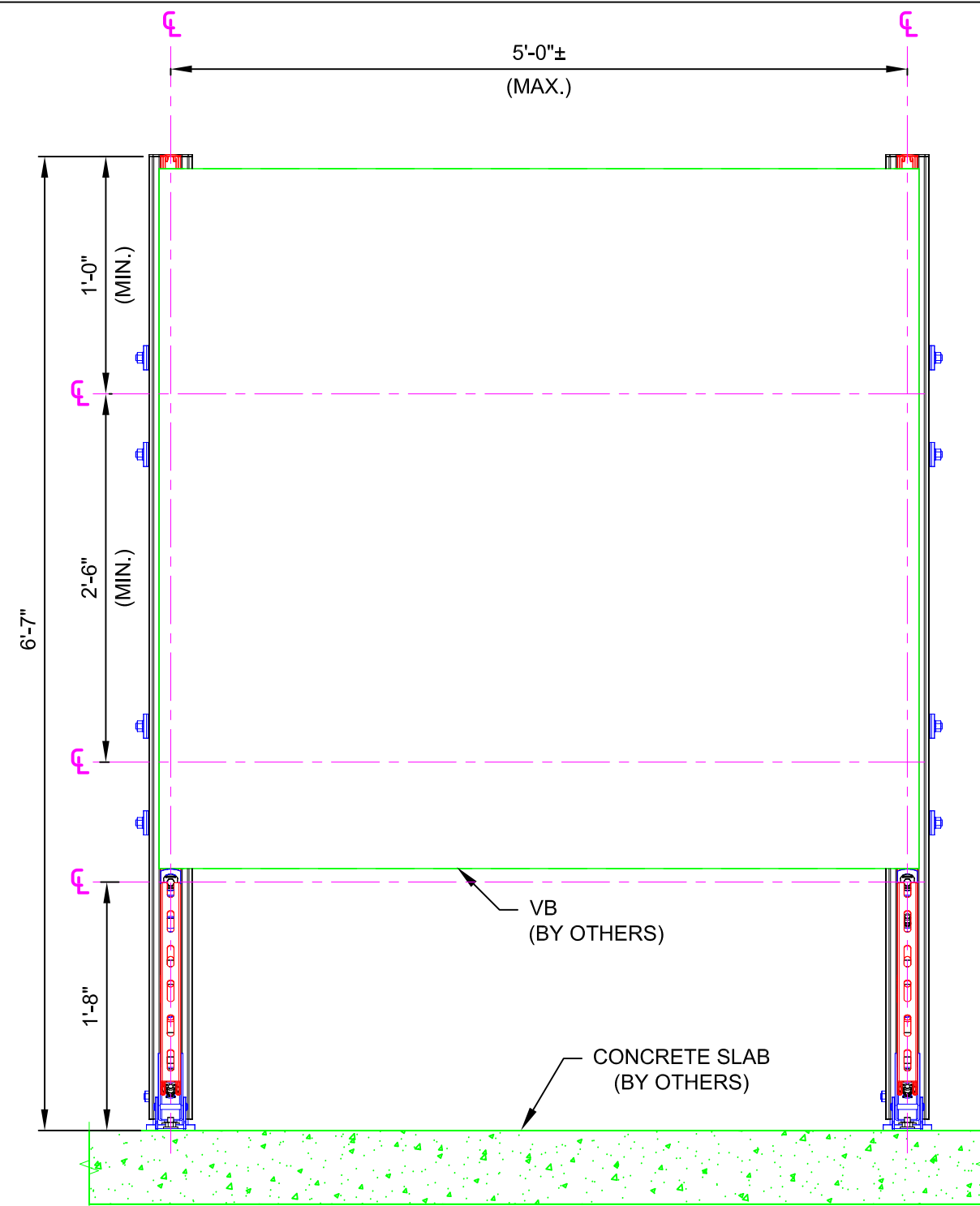

02 ELEVATION
N.T.S.

- NOTE(S):**
- PRELIMINARY NOT FOR CONSTRUCTION
 - DESIGN ASSUMPTIONS:
 - DESIGN LOADS (STATIC, U.N.O.):
DL: HC-MVB BOX = 800 lbs.
EL: 256 lbs.
 - BUILDING CODE: IBC 2012
 - CORROSION RESISTANCE REQD.: EG/HDG
 - REFER TO COMPONENT MANUFACTURER'S IFUs FOR REQUIRED INSTALLATION INFO.
 - E.O.R. MUST BE NOTIFIED OF ANY DEVIATIONS FROM EXISTING/ NEW SUBSTRATE CONDITIONS SHOWN HEREIN TO VALIDATE ACCEPTANCE OF THIS HILTI DESIGN PRIOR TO INSTALLATION. * ATTACH MQ TO MI USING #11 AND #12. USE (2) FOR HORIZONTAL ATTACHMENT (PLUS BOLT INCLUDED WITH MIC-90-L AT EACH END), AND (4) FOR VERTICAL ATTACHMENT.

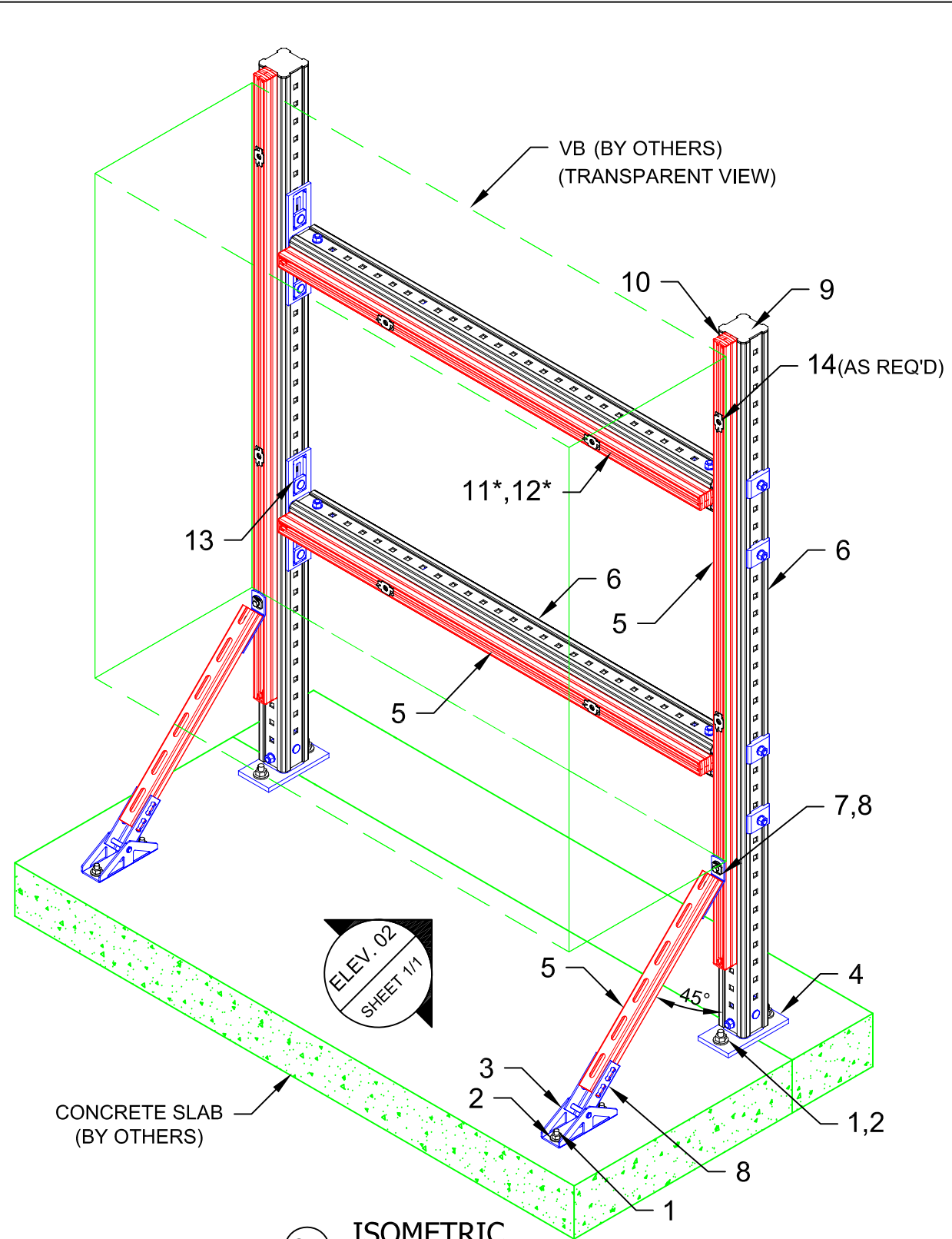

01 ISOMETRIC
N.T.S.

No.	Unit Qty	Unit	Description	Box Qty	# Boxes Needed	Item No.
1	8	EA	USE 3/8" KHEZ AS APPROPRIATE	VARIES	VARIES	VARIES
2	8	EA	WASHER 1/2"	100	1	411758
3	2	EA	RAIL SUPPORT MQP-G	10	1	369654
4	2	EA	CONNECTOR MIC-C90-AA CONCRETE	2	1	304825
5	AS REQ'D	EA	STRUT HS-158-12/PG 10'	1	AS REQ'D	407555
6	AS REQ'D	EA	GIRDER MI-90 3M	1	AS REQ'D	304798
7	2	EA	3-HOLE ANGLE MQW-3/45	20	1	369657
8	12	EA	CHANNEL CONNECTOR MQN	50	1	369623
9	2	EA	GIRDER END CAP MIA-EC90	25	1	432077
10	8	EA	CHANNEL END CAP MEK RED	50	1	244886
11	12	EA	ONEHAND SCREW MIA-OH90	10	2	304889
12	12	EA	MI HEX NUT M12-F-SL-WS 3/4"	100	1	382897
13	4	EA	CONNECTOR MIC-90-L	2	2	304805
14	8	EA	WING NUT MQM-F1/2"	50	1	377883